

EMPLEX SYSTEMS INC.

The Bagging Solutions Company



*Fusion 5
Hot Air Sealer*

THE FUSION EVOLUTION

For more than a quarter of a century, Emplex has proven itself the leader in the development of bag sealing equipment. Working closely with our customers, we have listened and learned, gaining the knowledge necessary to continually evolve and stay at the forefront of our industry. Now Emplex offers the latest in hot air sealing technology. Designed with operator efficiency in mind, the Fusion 5 hot air sealers increase ease of use and offer utmost flexibility. Through a band-less, non-contact sealing process, the Fusion 5 is designed to maximize production in harsh or dusty environments that may include; agriculture, horticulture, chemical, powder, food and many other high-demand applications.

The Fusion 5

The Fusion 5 hot air sealer is a continuous feed sealer designed to create strong seals on pillow-style bags without the use of bands. Utilizing 12" of concentrated heating to melt and fuse the bag material, seals are then set via crimp rollers. Seal widths range from the standard 1/4" up to 1/2". Precise variable temperature, speed and pressure controls accommodate for variations in bag thickness or composition ensuring the best seal every time. With standard variable speed, optional horizontal or vertical sealing orientation, and a choice of 120 or 220 volt electrical, the Fusion 5 can be easily integrated with existing or fully automated packaging systems. A standard safety interlock switch shuts down the machine when the control panel is opened, and a three-way switch allows for proper cool down which extends the life of the machine. The Fusion 5 series of sealers also offers many more options to tackle a wide variety of sealing requirements.



▼ Designed for Harsh or Dusty Applications

Due to the very nature of the Fusion 5's sealing process, this unit is especially suited to dusty, dirty, industrial types of environments. The concentrated stream of hot air which fuses the bag material blows soot, dust, flakes or other friable materials clean out of the way, leaving behind a neat seal. Applications may include the packaging of sands, salts and gravels; soils, bark or other agricultural products; a variety of powders and chemicals; varying food products; and many other dusty materials.

▼ Washdown Models

For extremely dirty, high-demand, or food processing applications, optional washdown units are available. Heavy-duty enclosures protect the control boxes and the Fusion 5's few internal moving components are invulnerable to thorough washdown procedures.

▼ Add-On Versatility

A number of add-on options modify and enhance the sealing functionality of the Fusion 5. These options include: trimmers, printers, embossers, conveyors, perforation units, and more. The add-on principle means you can adapt any of these options at any time to the sealing unit, even after the purchase to accommodate changing production needs — making the Fusion 5 the most versatile hot air sealer on the market today.

▼ Minimized Seal to Product Distance

The Fusion 5 machines reduce empty space found between the product and seal to its smallest physical limit, thereby reducing bag wastage, increasing shipping volume, and enhancing product appearance. In addition, the Fusion 5 is designed with a 3" deep sealing throat to make bag feeding easy. The operator can gain a firm grip on a good portion of the bag top, resulting in straight, fast and consistent feeding.

▼ Strong Support Capability

Emplex's exclusive infeed system is capable of supporting significant bag weights without the use of a conveyor. Typically, the Fusion 5 can support a 10" wide bag containing 2 pounds of product. More weight can be supported with wider bags and less weight is supported as the bag narrows. For bags that require more support, a conveyor can be readily and simply added to the unit.

▼ Fast Routine Maintenance

Since the Fusion 5 does not use bands for the sealing process, routine maintenance is quick and easy. Simple to use drop-down rails allow for quick access to the sealing section for cleaning and heater capsule replacement. The Fusion 5's control box also designed for easy access to the sealer's internal components. And simple dis-assembly of the unit's add-on options keep routine maintenance time to a minimum.

▼ Unique Stand Design

This robust anodized aluminum stand is as functional as it is durable. Built conveyor-ready, the two-post corrosion-resistant stand easily and infinitely adjusts the sealing head and conveyor heights to suit your specific bag sizes.

Fusion 5 Options

Conveyor

A conveyor is required for bag weights greater than 2 pounds, or for particular product orientation. All conveyors are stainless steel, food-grade belt conveyors complete with adjustable guide rails. Standard conveyor size is 6" W x 6' L, with a full family of conveyor options and sizes available to meet your specific needs. Effortless to mount and easy to adjust with a latch mechanism, Fusion 5 conveyors are manually raised and lowered to match any size bag. Master/follower drives, which synchronize conveyor and sealing speeds through an electronically geared system, are standard on all conveyorized units. Utilizing an 1/8 HP motor on the conveyor, the Fusion 5 easily handles heavy bags for high-demand production.

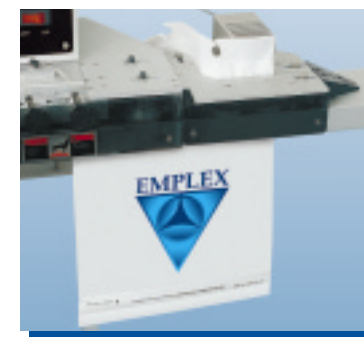

Trimmer

The TR60 bag top trimmer sits on the front end of the rails and is easily and quickly removed for servicing or non-trimmed sealing. Its rotary blade is height adjustable for accurate trim positioning, and can be set to eliminate the "tail" produced above the seal (perfect for shrink bags). Scrap is positively removed by our trim belt system, so there is no need for fan blowers or vacuum systems.

Embosser

Ideal for lot or date coding, the ER60 embossing unit holds 8 to 20 characters of standard type or 13 to 26 characters of slim type. The ER60 is available in single or double line versions, and is located on the exit-end of the rails so that the emboss code may be positioned above, below or directly on the seal.



Printer

The PR60 ink printer is capable of holding up to 13 characters per line and is also ideal for lot or date coding. This printer features adjustable type pressure and comes in single, double, or triple line versions. A range of ink colors are available upon request. The PR60 unit is located on the exit-end of the rails so that the printed code may be positioned above, below or directly on the seal.

Additional Options

- ▼ Perforation unit
- ▼ 120 or 220 volt electrical
- ▼ Left to right infeed
- ▼ Casters
- ▼ Horizontal or vertical sealing
- ▼ Varying, interchangeable seal widths

DIMENSIONAL DRAWINGS

CAD drawings of the MPS Series in .DXF format are available upon request.

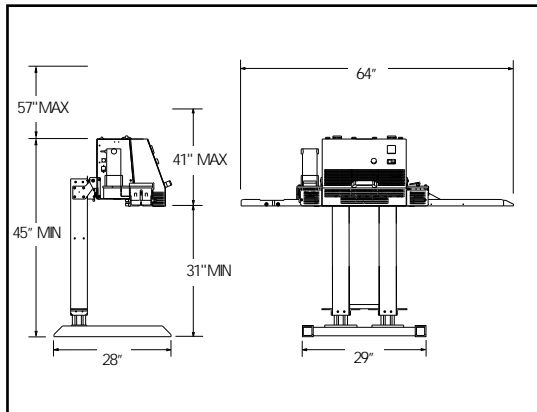

Fusion 5 (Standard)

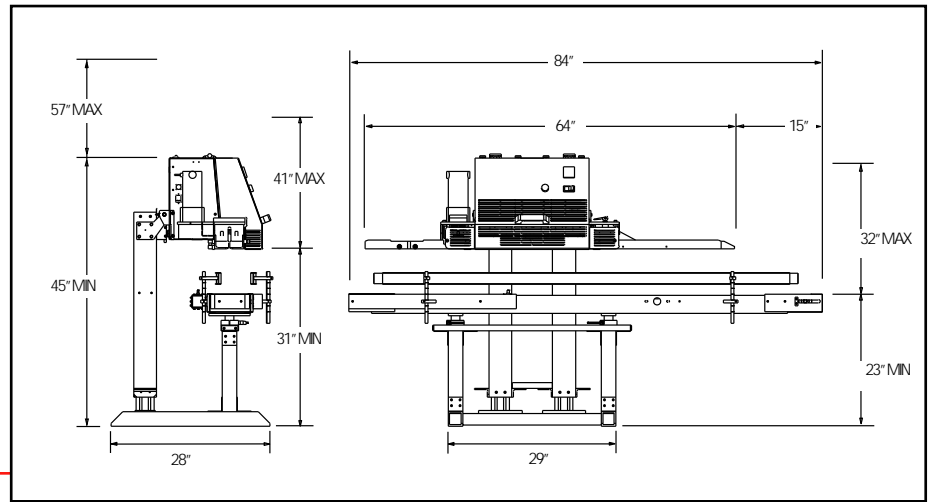

Fusion 5 (Conveyorized)

Technical Specifications of the Fusion 5

Operation:	Manual or fully-automatic
Electrical:	115 VAC, 1 PH, 60 Hz, 1955 W, 17amp
Motor:	Variable speed DC drive
Speed:	Variable up to 750" per minute
Temperature Controller:	PID autotune temperature controller
Temperature Range:	32 - 572F (0 - 300°C)
Seal Width:	1/4"
Materials:	Anodized aluminum, stainless steel, and delrin
Weight:	Sealing head (incl. stand): approx. 160 pounds Conveyor: approx. 58 pounds

CONTACT INFORMATION

For more information on our full product line or to receive an Emplex video please contact:
EMPLEX SYSTEMS INC., 2045 Midland Avenue, Toronto, ON, M1P 3E2

Telephone: 416-291-8085
Toll Free Line: 800-265-1775
Fax: 416-298-HEAT (4328)
Email: info@emplex.com
Website: www.emplex.com

Emplex Machinery Distributed By: